

RSC Radial Lead Type

series

- Super low ESR, High ripple current
- Large capacitance, Small size
- Load life of 20,000h at 105°C



SPECIFICATIONS

Items	Characteristics	
Temperature range	-55 to +105°C	
Rated voltage range	2.5 to 25Vdc	
Capacitance range	82 to 1,500μF	
Capacitance tolerance	±20% [M] (at 20°C, 120Hz)	
Tangent of loss angle	Less than or equal to the value of Standard Ratings (at 20°C, 120Hz)	
Leakage current	Less than or equal to the value of Standard Ratings (at 20°C, after 2 minutes)	
ESR	Less than or equal to the value of Standard Ratings	
Characteristics of impedance	Z _{+105°C} /Z _{+20°C} ≤ 1.25, Z _{-55°C} /Z _{+20°C} ≤ 1.25 at 100kHz	
Endurance	105°C, 10,000 hrs at rated voltage	
	Appearance	No significant damage
	Capacitance change	Within±20% of the initial value
	Tangent of loss angle (tanδ)	≤150% of the initial specified value
	ESR(mΩ)	≤150% of the initial specified value
	Leakage current	≤The initial specified value
Damp Heat (Steady State)	60°C, 90 to 95% RH, 1,000 hrs, No-applied Voltage	
	Appearance	No significant damage
	Capacitance change	Within±20% of the initial value
	Tangent of loss angle (tanδ)	≤150% of the initial specified value
	ESR(mΩ)	≤150% of the initial specified value
	Leakage current	≤The initial specified value
Resistance to soldering heat	Flow method (260±5°C, 10s)	
	Appearance	No significant damage
	Capacitance change	Within±10% of the initial value
	Tangent of loss angle (tanδ)	≤130% of the initial specified value
	ESR(mΩ)	≤130% of the initial specified value
	Leakage current	≤The initial specified value

*In case of some problems for measured values, measure after applying rated voltage for 120 minutes at 105°C

SIZE LIST

μF	RV(SV)						(unit : mm)
	2.5 (3.3)	4 (5.2)	6.3 (8.2)	16 (18.4)	20 (23)	25 (28.7)	
82							6.3 x 9
100				6.3 x 6			
180					8 x 9	8 x 11.5	
270				8 x 7			
330							10 x 11.5
470		6.3 x 9		10 x 11.5	10 x 11.5		
560	6.3 x 9	6.3 x 9					
680			6.3 x 9				
820	8 x 9		6.3 x 9				
1500	8 x 9						

*RV : Rated Voltage [V] SV : Surge Voltage [V] (at room temperature)

MARKING AND DIMENSIONS

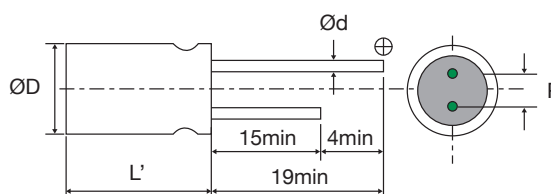
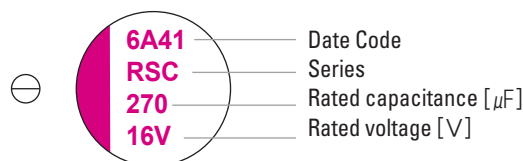

Size	ØD±0.5	L	L'	P±0.5	Ød
6.3 x 6	6.3	6		2.5	0.45
8 x 7	8	7		3.5	0.45
6.3 x 9	6.3	9	L max.	2.5	0.6
8 x 9	8	9		3.5	0.6
8 x 11.5	8	11.5	L + 1.0	3.5	0.6
10x11.5	10	11.5	max.	5	0.6

STANDARD RATINGS

Rated Voltage [Vdc]	Rated Capacitance [μF]	Size Φ D x L [mm]	ESR (20°C, 100kHz) [mΩ] [max.]	Rated Ripple Current (105°C, 100kHz) [mA rms]	Tangent of Loss Angel [max.]	Leakage Current [μA, max.]	Part Number
2.5	560	6.3 x 9	7	5600	0.1	500	2RSC560MC9
	820	8 x 9	7	5900	0.1	500	2RSC820MD9
	1500	8 x 9	7	6100	0.1	750	2RSC1500MD9
4	470	6.3 x 9	7	5600	0.1	500	4RSC470MC9
	560	6.3 x 9	7	5600	0.1	500	4RSC560MC9
6.3	680	6.3 x 9	7	4000	0.1	856	6RSC680MC9
	820	6.3 x 9	7	4700	0.1	1033	6RSC820MC9
16	100	6.3 x 6	24	2490	0.1	320	16RSC100MC6
	270	8 x 7	10	5000	0.1	864	16RSC270MD7
	470	10 x 11.5	10	6100	0.1	1504	16RSC470ME11
20	180	8 x 9	18	3500	0.1	720	20RSC180MD9
	470	10 x 11.5	15	5000	0.1	1880	20RSC470ME11
25	82	6.3 x 9	28	2780	0.1	410	25RSC82MC9
	180	8 x 11.5	16	4650	0.1	900	25RSC180MD11
	330	10 x 11.5	14	5000	0.1	1650	25RSC330ME11